

Contact information

Frank Bruggeman
f.j.bruggeman@vu.nl
 Systems Bioinformatics
 Room: P214
 VU University
 De Boelelaan 1087
 1081 HV
 Amsterdam

Course material can be found at: <http://www.teusinklab.nl/teaching/>

Course schedule

| Monday, Nov 23 | | | |
|--------------------------|---|-------|--|
| 09:30-10:30 | Dimensions, diffusion, reactions | Frank | WN-P663 |
| 10:30-11:00 | Coffee | | |
| 11:00-12:30 | Mass balances and mass-action kinetics | Frank | |
| 12:30-13:30 | Lunch | | |
| 13:30-15:00 | Enzyme kinetics | Frank | IN-3B50 (13:30-14:30) WN-F619 (14:30-15:00) |
| 15:00-15:30 | Coffee | | WN-F619 |
| 15:30-17:30 | Enzyme kinetics | Frank | |
| Tuesday, Nov 24 | | | |
| 09:30-10:30 | JWS online, basics | Jacky | WN-F619 |
| 10:30-11:00 | Coffee | | |
| 11:00-12:30 | JWS online, basics | Jacky | |
| 12:30-13:15 | Lunch | | |
| 13:15-15:00 | Simulating differential equation models | Jacky | WN-M623 |
| 15:00-15:30 | Coffee | | |
| 15:30-17:30 | JWS Online; edit, build and export models | Jacky | |
| Wednesday, Nov 25 | | | |
| 09:30- | Rate characteristics and small | Evert | HG-07A16 |

| | | | |
|--|---|-------|----------|
| 10:30 | networks | | |
| 10:30 | Coffee | | |
| 11:00-12:30 | Supply demand theory and ultrasensitivity | Evert | |
| 12:30-13:30 | Lunch | | HG-10A20 |
| 13:30-15:00 | Metabolic Control Analysis | Jacky | WN-P647 |
| 15:00-15:30 | Coffee | | |
| 15:30-17:30 | Mathematical model application: Biotech | Jacky | |
| Thursday, Nov 26 | | | |
| 09:30-10:30 | Cool systems: kinetic proofreading, TF-DNA search, robustness, fold-change detection, optimal gene expression | Evert | WN-M212 |
| 10:30-11:00 | Coffee | | |
| 11:00-12:30 | Cool systems: kinetic proofreading, TF-DNA search, robustness, fold-change detection, optimal gene expression | Evert | |
| 12:30-13:30 | Lunch | | |
| 13:30-15:00 | Model application: Health | Jacky | WN-C638 |
| 15:00-15:30 | Coffee | | |
| 15:30 | Model construction, validation, and publication; reproducibility and standards | Jacky | |
| Friday, Nov 27 (Several Topics in a Nutshell) | | | |
| 09:30-10:45 | Stoichiometric analysis, N, K, L | Frank | WN-F619 |
| 10:45-11:15 | Coffee | | HG-09A16 |
| 11:15-12:30 | Flux balance analysis | Frank | |
| 12:30-13:00 | Lunch | | |

| | | | |
|-------------|--|-------|---------|
| 13:00-15:00 | Stability analysis, phase-plane analysis | Frank | WN-M607 |
| 15:00-15:30 | Coffee | | |
| 15:30-17:30 | Bistability and oscillations with JWS Online | Jacky | |

HG-building

WN-building

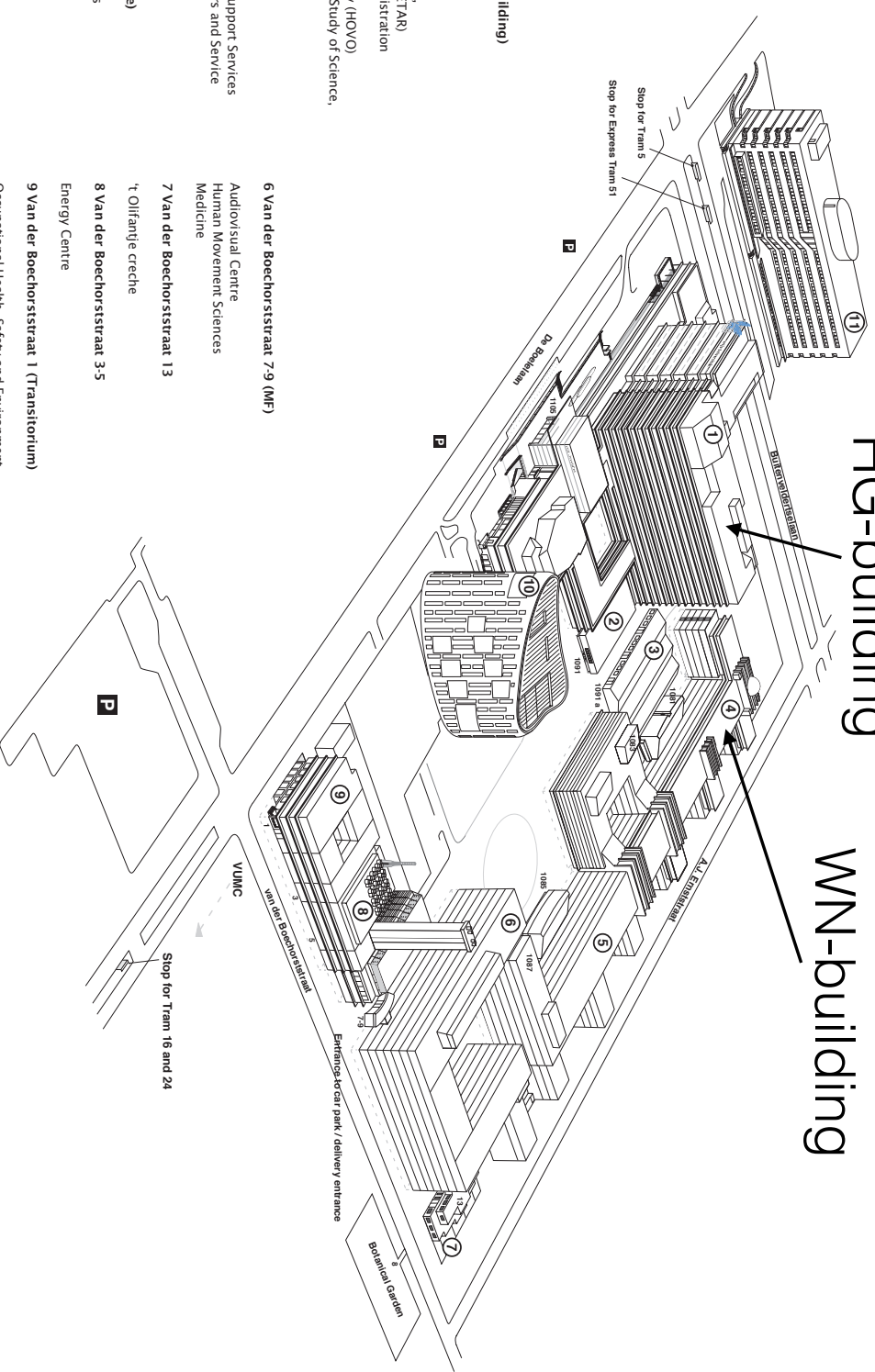

Visitor's guide

1 De Boelelaan 1105 (main building)

- Arts
- Auditorium
- Aula
- Centre for Educational Training, Assessment and Research (CETAR)
- Economics and Business Administration
- Executive Board
- Higher Education for the Elderly (HOVO)
- Interdisciplinary Centre for the Study of Science, Society and Religion
- Law
- Library
- Reception
- Theology
- University Administrative and Support Services (Office for Management Affairs and Service Departments)
- VU Association

2 De Boelelaan 1091 (Bellevue)

Department of Communications

3 De Boelelaan 1091a

'De Tent', examination hall

4 De Boelelaan 1081 (W&N)

Physics and Astronomy
Mathematics and Computer Science
Chemistry

5 De Boelelaan 1085 (W&N)

Earth and Life Sciences
Radioncology Centre
Institute for Environmental Studies

6 Van der Boechorstraat 79 (MF)

Audiological Centre
Human Movement Sciences
Medicine

7 Van der Boechorstraat 13

t. Olfantje creche

8 Van der Boechorstraat 3-5

Energy Centre

9 Van der Boechorstraat 1 (Transitorium)

Occupational Health, Safety and Environment
Psychology and Education

10 De Boelelaan 1109 (OZV)

Educational Institute for Care and Welfare

11 Buitenvelderslaan 3 (Metropolitan)

Social Sciences
Centre for International Cooperation